

Other Product Range

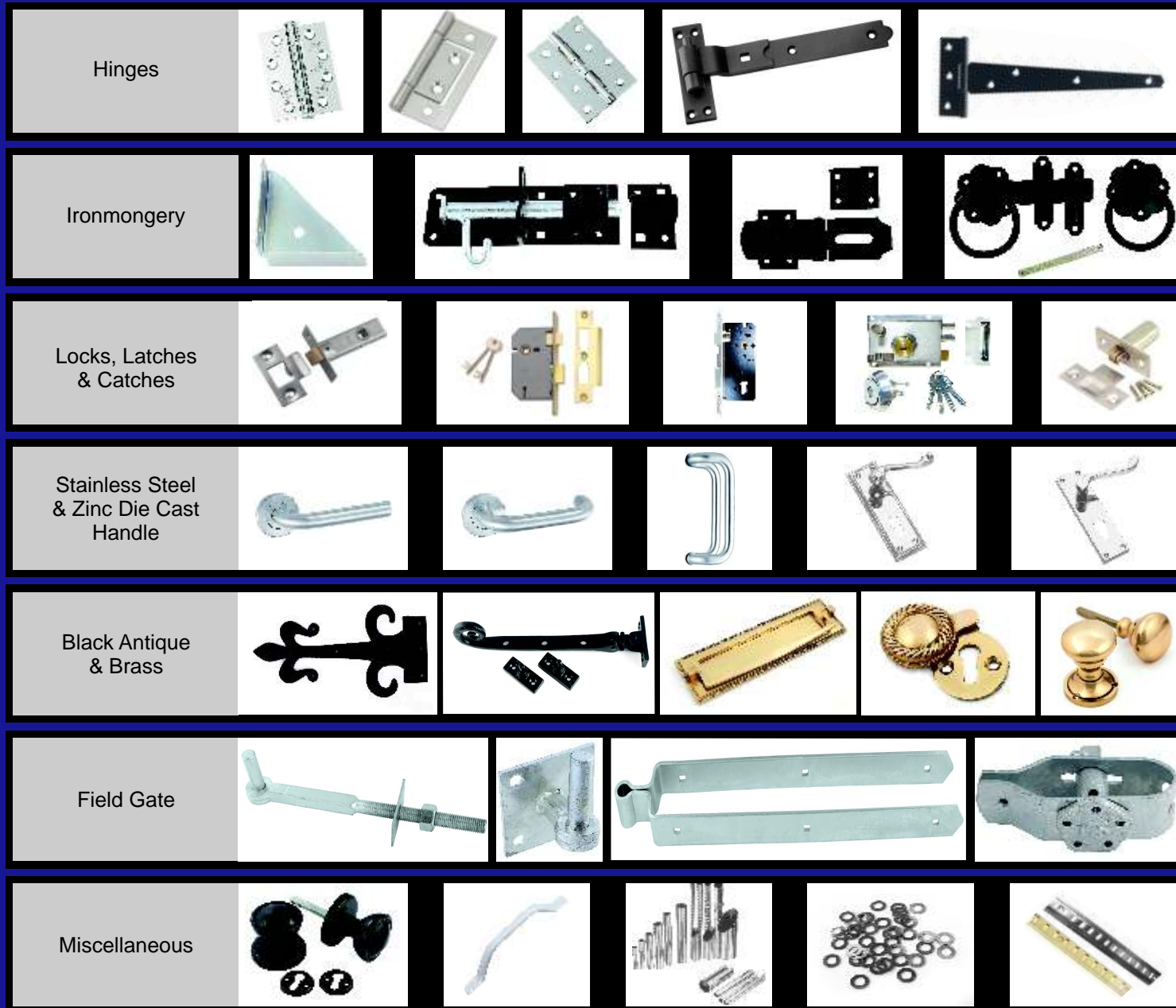

Garg

ISO 9001 : 2008 CERTIFIED COMPANY

Aluminium



D. P. GARG & CO. PVT. LTD.

An ISO : 9001 : 2008 , 14001 : 2004, 18001 : 2007 Certified Company

A Government of India Recognised Star Export House

B-210 B, Phase - 2, Noida - 201305 (U.P.) INDIA

Ph.: +91-120-2460071, 2460085 to 87, 3290554, 3290445 Fax : +91-120-2460083, 2424519, 2424452

Email : smg@garg-hinges.com

Visit us at : www.garg-hinges.com, www.garglocks.co.in , www.elitelocks.co.in



Quality the World Trusts



ALUMINIUM DOOR, WINDOW FURNITURE & FITTINGS

CODE	DESCRIPTION	PAGE	CODE	DESCRIPTION	PAGE
ALUMINIUM DOOR HANDLES					
STEPHENSON					
GA1001	LEVER LOCK FURNITURE	03	GA1131	FINGER PLATE PULL	05
GA1002	LEVER LATCH FURNITURE	03	GA1141	KICK PLATE ROUND EDGE COUNTERSUNK HOLE 30"	06
GA1003	EURO PROFILE FURNITURE	03	GA1142	KICK PLATE ROUND EDGE COUNTERSUNK HOLE 33"	06
GA1004	BATHROOM & PRIVACY FURNITURE	03	GA1143	KICK PLATE ROUND EDGE COUNTERSUNK HOLE 34"	06
BRUNEL					
GA1021	LEVER LOCK FURNITURE	03	GA1144	KICK PLATE ROUND EDGE COUNTERSUNK HOLE 36"	06
GA1022	LEVER LATCH FURNITURE	03	GA1201	FRONT FIX LETTER PLATE 10"	06
GA1023	EURO PROFILE FURNITURE	03	GA1202	FRONT FIX LETTER PLATE 12"	06
GA1024	OVAL PROFILE FURNITURE	03	GA1201T	FRONT FIX LETTER PLATE & TIDY	06
GA1025	BATHROOM & PRIVACY FURNITURE	03	GA1211	REAR FIX LETTER PLATE	07
LOWE					
GA1041	LEVER LOCK FURNITURE	03	GA1221	INNER FLAP 10"	07
GA1042	LEVER LATCH FURNITURE	03	GA1222	INNER FLAP 12"	07
GA1043	EURO PROFILE FURNITURE	03	GA1311	ROUND BAR PULL HANDLE- CONCEALED FIX 6"	07
GA1044	BATHROOM & PRIVACY FURNITURE	03	GA1312	ROUND BAR PULL HANDLE- CONCEALED FIX 9"	07
GA1045	OVAL PROFILE FURNITURE	03	GA1313	ROUND BAR PULL HANDLE- CONCEALED FIX 12"	07
WHITWORTH					
GA1061	LEVER LOCK FURNITURE	04	GA1314	ROUND BAR PULL HANDLE- CONCEALED FIX 18"	07
GA1062	LEVER LATCH FURNITURE	04	GA1315	ROUND BAR PULL HANDLE- BOLT THROUGH FIXING 6"	08
GA1063	EURO PROFILE FURNITURE	04	GA1316	ROUND BAR PULL HANDLE- BOLT THROUGH FIXING 9"	08
GA1064	BATHROOM & PRIVACY FURNITURE	04	GA1317	ROUND BAR PULL HANDLE- BOLT THROUGH FIXING 12"	08
GA1065	OVAL PROFILE FURNITURE	04	GA1321	OVAL GRIP PULL HANDLE 9"	08
RUTHERFORD					
GA1081	LEVER LOCK FURNITURE	04	GA1322	OVAL GRIP PULL HANDLE 12"	08
GA1082	LEVER LATCH FURNITURE	04	GA1341	BOW HANDLE	08
GA1083	EURO PROFILE FURNITURE	04	GA1351	D" HANDLE 4"	09
GA1084	OVAL PROFILE FURNITURE	04	GA1352	D" HANDLE 6"	09
GA1085	BATHROOM & PRIVACY FURNITURE	04	GA1411	OPEN ESCUTCHEON	09
GA1086	CONCEALED FIX ROUND ROSE LATCH	05	GA1412	COVERED ESCUTCHEON	09
ALUMINIUM HARDWARE FITTINGS					
GA1087	CONCEALED FIX KEYLOCK ESCUTCHEON	05	GA1421	CYLINDER PULL	09
GA1088	CON. FIX EURO PROFILE LOCK ESCUTCHEON	05	GA1423	CYLINDER PULL EURO PROFILE	10
GA1089	CON. FIX OVAL PROFILE LOCK ESCUTCHEON	05	GA1425	CYLINDER PULL OVAL PROFILE	10
GA1090	BATHROOM INDICATOR	05	GA1431	INDICATOR BOLT	10
GA1101	FINGER PLATE	05	GA1451	FLUSH PULL	10
GA1121	FINGER PLATE PUSH	05	GA1461	DISHED CUPBOARD KNOB 32MM	10
			GA1462	DISHED CUPBOARD KNOB 38MM	10



ALUMINIUM DOOR, WINDOW FURNITURE & FITTINGS

CODE	DESCRIPTION	PAGE	CODE	DESCRIPTION	PAGE
GA1475	HANDRAIL BRACKET	11	GA1604	BARREL BOLT 4"	13
GA1481	HAT & COAT HOOK	11	GA1605	BARREL BOLT 6"	13
GA1482	WARDROBE HOOK	11	13GA1651	NECKED BARREL BOLT 3"	13
GA1483	TOILET ROLL HOLDER	11	GA1652	NECKED BARREL BOLT 4"	13
GA1483A	TOILET ROLLER	12	GA1653	NECKED BARREL BOLT 6"	13
GA1484	TUBULAR DOOR STOP 3"	12	GA1671	FLUSH BOLT 6"	14
GA1485	TUBULAR DOOR STOP 2.5"	12	GA1672	FLUSH BOLT 8"	14
GA1486	OVAL SHEILD DOOR STOP	12	GA1700	MALE SELF ADHESIVE FIX	14
GA1488	ROUND SHEILDED DOOR STOP	12	GA1701	FEMALE SELF ADHESIVE FIX	14
GA1550	CASEMENT STAY 8"	13	GA1702	DISABLED SELF ADHESIVE FIX	14
GA1551	CASEMENT STAY 10"	13	GA1710	PUSH PLATES ADHESIVE	14
GA1555	CASEMENT STAY HEAVY PATTERN 12"	13	GA1711	PULL PLATES	14
GA1561	CASEMENT FASTENER	13	GA1851	SASH LIFT 2"	14
GA1601	BARREL BOLT 2"	13	GA1852	SASH LIFT HEAVY	15
GA1602	BARREL BOLT 2.5"	13	GA1061A	SPINDLE FOR LOCK & LATCHES 125MM	15
GA1603	BARREL BOLT 3"	136	GA1061B	SPINDLE FOR LOCK & LATCHES 90MM	15
				ALPHABETICAL INDEX	16

***NOTE : ALL WEIGHTS GIVEN IN KGS & LENGTHS IN MM UNLESS MENTIONED**



THE STEPHENSON



NAME	DPG CODE	ITEM CODE	LENGTH	WIDTH	CENTRE DISTANCE	SCREW NO.	WT/SET	Set In Inner	Set In Outer
LEVER LATCH	GA1002	AHND1002075	79	44	-	7	0.293	1	25
LEVER LOCK	GA1001	AHND1001150	150	42	57	7	0.333	1	10
PRIVACY & BATHROOM	GA1004	AHND1004150	150	42	57	7	0.445	1	10
EURO PROFILE	GA1003	AHND1003150	150	42	47.5	7	0.333	1	10

Finish Available : SAA, PAA

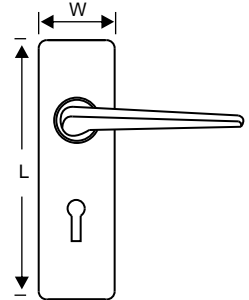

THE BRUNEL



NAME	DPG CODE	ITEM CODE	LENGTH	WIDTH	CENTRE DISTANCE	SCREW NO.	WT/SET	Set In Inner	Set In Outer
LEVER LATCH	GA1022	AHND1022100	103	39	-	7	0.222	1	25
LEVER LOCK	GA1021	AHND1021150	153	38	57	7	0.241	1	10
PRIVACY & BATHROOM	GA1025	AHND1025150	153	38	57	7	0.266	1	10
EURO PROFILE	GA1023	AHND1023150	153	38	47.5	7	0.239	1	10
OVAL PROFILE	GA1024	AHND1024150	153	38	48.5	7	0.253	1	10

Finish Available : SAA, PAA

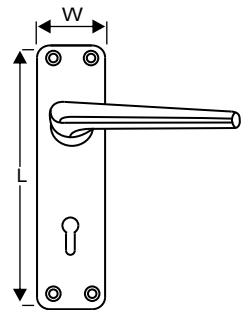

THE LOWE



NAME	DPG CODE	ITEM CODE	LENGTH	WIDTH	CENTRE DISTANCE	SCREW NO.	WT/SET	Set In Inner	Set In Outer
LEVER LATCH	GA1042	AHND1042100	100	38	-	8	0.228	1	25
LEVER LOCK	GA1041	AHND1041150	155	38	57	8	0.240	1	10
PRIVACY & BATHROOM	GA1044	AHND1044150	153	38	57	8	0.273	1	10
EURO PROFILE	GA1043	AHND1043150	154	38	47.5	8	0.220	1	10
OVAL PROFILE	GA1045	AHND1045150	154	38	48.5	8	0.246	1	10

Finish Available : SAA, PAA

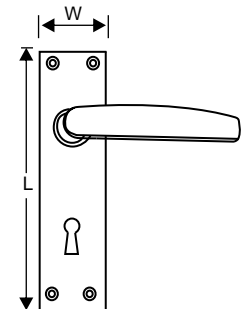

THE WHITWORTH



NAME	DPG CODE	ITEM CODE	LENGTH	WIDTH	CENTRE DISTANCE	SCREW NO.	WT/SET	Set In Inner	Set In Outer
LEVER LATCH	GA1062	AHND1062100	103	39	-	7	0.214	1	25
LEVER LOCK	GA1061	AHND1061150	153	38	57	7	0.223	1	10
PRIVACY & BATHROOM	GA1064	AHND1064150	153	38	57	7	0.323	1	10
EURO PROFILE	GA1063	AHND1063150	153	38	47.5	7	0.220	1	10
OVAL PROFILE	GA1065	AHND1065150	153	39	48.5	7	0.231	1	10

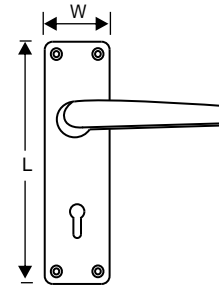

Finish Available : SAA, PAA

THE RUTHERFORD



NAME	DPG CODE	ITEM CODE	LENGTH	WIDTH	CENTRE DISTANCE	SCREW NO.	WT/SET	Set In Inner	Set In Outer
LEVER LATCH	GA1082	AHND1082150	150	43	-	7	0.510	1	25
LEVER LOCK	GA1081	AHND1081150	150	43	57	7	0.501	1	10
PRIVACY & BATHROOM	GA1085	AHND1085150	150	42	57	7	0.531	1	10
EURO PROFILE	GA1083	AHND1083150	150	43	47.5	7	0.592	1	10
OVAL PROFILE	GA1084	AHND1084150	150	42	48.5	7	0.503	1	10

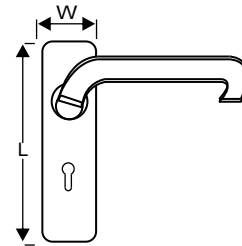

Finish Available : SAA, PAA

CONCEALED FIX ROUND ROSE LATCH (RUTHERFORD)



DPG CODE	ITEM CODE	Rose Diameter	SCREW NO.	WT/SET	Set In Inner	Set In Outer
GA1086	AHND1086050	54	7	0.378	1	25

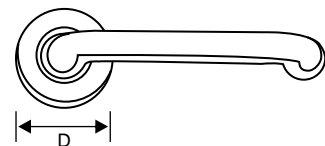

Finish Available : SAA, PAA

CONCEALED ESCUTCHEON



NAME	DPG CODE	ITEM CODE	Base Diameter	SCREW NO.	WT/PCS	Pcs In Inner	Pcs In Outer
KEYLOCK	GA1087	AMIH1087XXX	50	7	0.025	20	400
EURO PROFILE	GA1088	AMIH1088XXX	50	6	0.021	20	400
OVAL PROFILE	GA1089	AMIH1089XXX	50	6	0.019	20	400

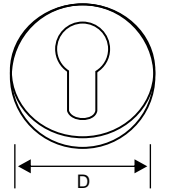

Finish Available : SAA, PAA

BATHROOM INDICATOR



DPG CODE	ITEM CODE	Base Diameter	SCREW NO.	WT/SET	Set In Inner	Set In Outer
GA1090	AMIH1090XXX	50	7	0.070	50	250

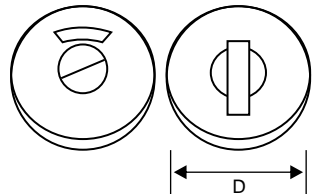

Finish Available : SAA, PAA

FINGER PLATE



NAME	DPG CODE	ITEM CODE	LENGTH	WIDTH	THICKNESS	SCREW NO.	WT/PCS	Pcs In Inner	Pcs In Outer
FINGER PLATE	GA1101	AMIH1101300	300	75	1.25	4	0.074	10	100
PUSH	GA1121	AMIH1121305	300	75	1.25	4	0.074	10	100
PULL	GA1131	AMIH1131305	300	75	1.25	4	0.074	10	100

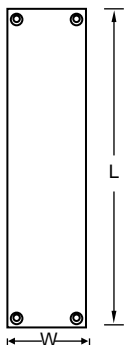

Finish Available : SAA, PAA

KICK PLATE ROUND EDGES COUNTERSUNK HOLES

DPG CODE	ITEM CODE	LENGTH	WIDTH	THICKNESS	SCREW NO.	WT/PCS	Pcs In Inner	Pcs In Outer
GA1141	AMIH1141750	750	152	1.2	4	0.342	10	50
GA1142	AMIH1141825	825	152	1.2	4	0.392	10	50
GA1143	AMIH1141850	850	200	1.2	4	0.482	10	50
GA1144	AMIH1141900	900	152	1.2	4	0.420	10	50

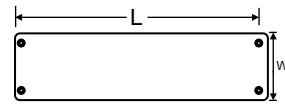

Finish Available : SAA, PAA
Note : Other Sizes Available on Request

FRONT FIX LETTER PLATE

DPG CODE	ITEM CODE	LENGTH	WIDTH	SCREW NO.	WT/PCS	Pcs In Inner	Pcs In Outer
GA1201	AMIH1201250	255	78	6	0.160	5	50
GA1202	AMIH1202300	305	78	6	0.200	5	50

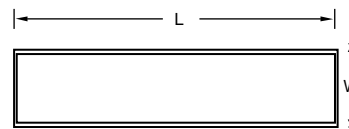

Finish Available : SAA, PAA

FRONT FIX LETTER PLATE & TIDY

DPG CODE	ITEM CODE	LENGTH	WIDTH	SCREW NO.	WT/SET	Set In Inner	Set In Outer
GA1201T	AMIH1203250	255	79	6	0.311	1	25

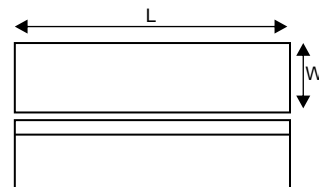

Finish Available : SAA, PAA

REAR FIX LETTER PLATE

DPG CODE	ITEM CODE	LENGTH	WIDTH	BOLT	WT/PCS	Pcs In Inner	Pcs In Outer
GA1211	AMIH1211250	252	76	M6	0.153	5	50

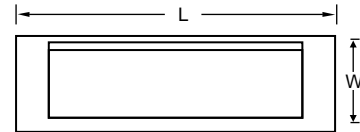

Finish Available : SAA, PAA

INNER FLAP

DPG CODE	ITEM CODE	LENGTH	WIDTH	SCREW NO.	WT/PCS	Pcs In Inner	Pcs In Outer
GA1221	AMIH1221250	251	68	6	0.106	5	50
GA1222	AMIH1222300	305	68	6	0.119	5	50

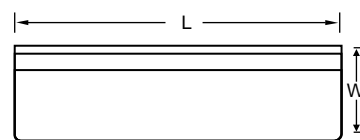

Finish Available : SAA, PAA

ROUND BAR PULL HANDLE - CONCEALED FIX



DPG CODE	ITEM CODE	LENGTH	WIDTH	HANDLE DIA	SCREW NO.	WT/PCS	Pcs In Inner	Pcs In Outer
GA1311	AHND1311150	150	50	19	6	0.224	5	50
GA1312	AHND1312225	225	50	19	6	0.276	5	50
GA1313	AHND1313300	304	50	19	6	0.331	5	50
GA1314	AHND1314450	450	50	19	6	0.448	2	30

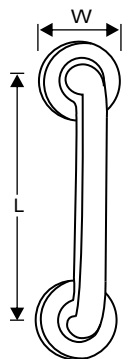

Finish Available : SAA, PAA

ROUND BAR PULL HANDLE - BOLT THROUGH FIXING



DPG CODE	ITEM CODE	LENGTH	WIDTH	DIAMETER	BOLT	WT/PCS	Pcs In Inner	Pcs In Outer
GA1315	AHND1315150	152	60	19	M8	0.163	10	80
GA1316	AHND1316225	225	60	19	M8	0.222	10	50
GA1317	AHND1317300	300	60	19	M8	0.280	10	50

Finish Available : SAA, PAA

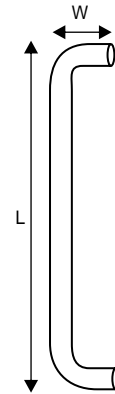

OVAL GRIP PULL HANDLE



DPG CODE	ITEM CODE	LENGTH	WIDTH	SCREW NO.	WT/PCS	Pcs In Inner	Pcs In Outer
GA1321	AHND1321225	231	25	10	0.202	10	80
GA1322	AHND1322300	305	25	10	0.310	5	50

Finish Available : SAA, PAA

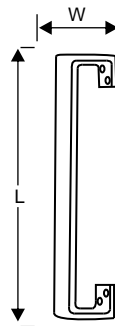

BOW HANDLE



DPG CODE	ITEM CODE	LENGTH	Base Diameter	SCREW NO.	WT/PCS	Pcs In Inner	Pcs In Outer
GA1341	AHND1341150	158	38	6	0.050	10	100

Finish Available : SAA, PAA



"D" HANDLE



ITEM CODE	ITEM CODE	LENGTH	WIDTH	DIAMETER	BOLT	WT/SET	Set In Inner	Set In Outer
GA1351	AHND1351100	110	36	9.5	M5	0.032	10	600
GA1352	AHND1352150	162	36	9.5	M5	0.044	10	500

Finish Available : SAA, PAA

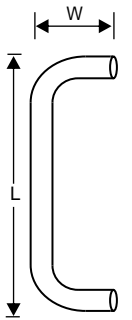

OPEN ESCUTCHEON



DPG CODE	ITEM CODE	Diameter	SCREW NO.	WT/PCS	Pcs In Inner	Pcs In Outer
GA1411	AMIH1411032	32	4	0.002	50	500

Finish Available : SAA, PAA

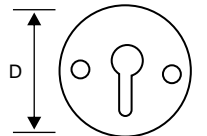

COVERED ESCUTCHEON



DPG CODE	ITEM CODE	Base Diameter	SCREW NO.	WT/PCS	Pcs In Inner	Pcs In Outer
GA1412	AMIH1412032	32	4	0.004	50	500

Finish Available : SAA, PAA

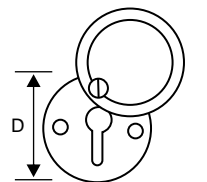

CYLINDER PULL



DPG CODE	ITEM CODE	LENGTH	WIDTH	WT/PCS	Pcs In Inner	Pcs In Outer
GA1421	AMIH1421064	72	44	0.025	20	400

Finish Available : SAA, PAA

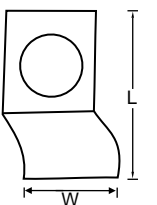

CYLINDER PULL



NAME	DPG CODE	ITEM CODE	LENGTH	WIDTH	THICKNESS	SCREW NO.	WT/PCS	Pcs In Inner	Pcs In Outer
EURO PROFILE	GA1423	AMIH1423096	96	43	1.9	7	0.021	20	200
OVAL PROFILE	GA1425	AMIH1425096	96	43	1.9	7	0.020	20	200

Finish Available : SAA, PAA

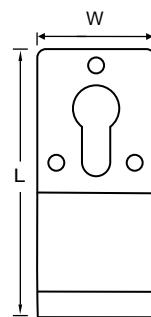

INDICATOR BOLT



DPG CODE	ITEM CODE	LENGTH	WIDTH	THICKNESS	SCREW NO.	WT/PCS	Pcs In Inner	Pcs In Outer
GA1431	AMIH1431070	67	33	1.3	4	0.070	10	100

Finish Available : SAA, PAA
Size Available : GA1432

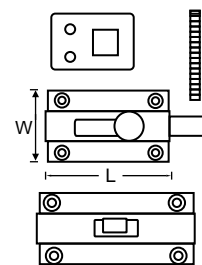

FLUSH PULL



DPG CODE	ITEM CODE	LENGTH	WIDTH	SCREW NO.	WT/PCS	Pcs In Inner	Pcs In Outer
GA1451	AMIH1451090	89	42	4	0.020	10	200

Finish Available : SAA, PAA

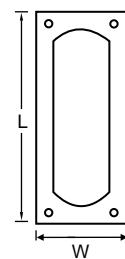

DISHED CUPBOARD KNOB



DPG CODE	ITEM CODE	LENGTH	KNOB DIA.	BOLT	WT/PCS	Pcs In Inner	Pcs In Outer
GA1461	AMIH1461032	19	33	M5	0.011	25	600
GA1462	AMIH1462038	19	40	M5	0.013	25	600

Finish Available : SAA, PAA

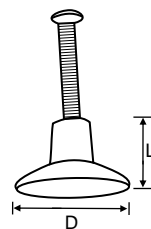

HANDRAIL BRACKET



DPG CODE	ITEM CODE	LENGTH	TOP PLATE	BASE DIA.	SCREW NO.	WT/PCS	Pcs In Inner	Pcs In Outer
GA1475	AMIH1475063	82	61X23	61	8	0.122	5	80

Finish Available : SAA, PAA
Size Available: 3" (GA1476)

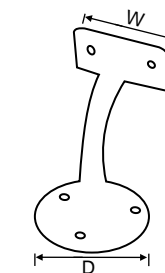

HAT & COAT HOOK



DPG CODE	ITEM CODE	LENGTH	WIDTH	THICKNESS	SCREW NO.	WT/PCS	Pcs In Inner	Pcs In Outer
GA1481	AMIH1481125	131	19	2.6	7	0.021	50	800

Finish Available : SAA, PAA



WARDROBE HOOK



DPG CODE	ITEM CODE	LENGTH	WIDTH	THICKNESS	SCREW NO.	WT/PCS	Pcs In Inner	Pcs In Outer
GA1482	AMIH1482050	46	19	2.5	6	0.008	50	500

Finish Available : SAA, PAA

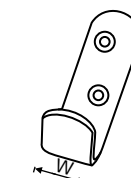

TOILET ROLL HOLDER



DPG CODE	ITEM CODE	LENGTH	WIDTH	THICKNESS	SCREW NO.	WT/PCS	Pcs In Inner	Pcs In Outer
GA1483	AMIH1483XXX	135	81	3.7	8	0.066	10	100

Finish Available : SAA, PAA

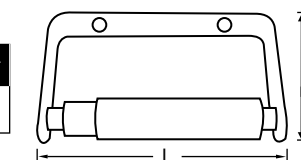

TOILET ROLLER



DPG CODE	ITEM CODE	LENGTH	BIG DIA.	SMALL DIA.	WT/PCS	Pcs In Inner	Pcs In Outer
GA1483A	PMIH1483XXX	125	22	18	0.015	10	100

Finish Available : SAA, PAA

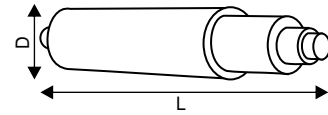

TUBULAR DOOR STOP



DPG CODE	ITEM CODE	LENGTH	Base Diameter	SCREW NO.	WT/PCS	Pcs In Inner	Pcs In Outer
GA1485	AMIH1485065	73	41	4	0.025	20	200
GA1484	AMIH1484075	86	41	4	0.029	20	200

Finish Available : SAA, PAA

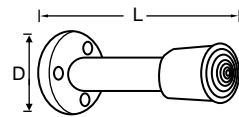

OVAL SHIELD DOOR STOP



DPG CODE	ITEM CODE	LENGTH	WIDTH	THICKNESS	SCREW NO.	WT/PCS	Pcs In Inner	Pcs In Outer
GA1486	AMIH1486XXX	48	41	2.2	6	0.040	10	100

Finish Available : SAA, PAA

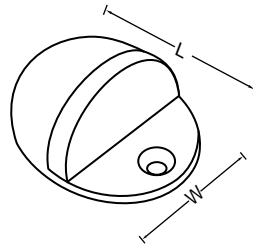

ROUND SHIELDED DOOR STOP



DPG CODE	ITEM CODE	LENGTH	DIA.	SCREW NO.	WT/PCS	Pcs In Inner	Pcs In Outer
GA1488	AMIH1488XXX	31	37	7	0.059	10	200

Finish Available : SAA, PAA

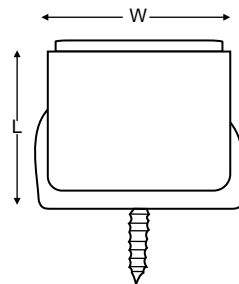

CASEMENT STAY



DPG CODE	ITEM CODE	LENGTH	WIDTH	SCREW NO.	WT/PCS	Pcs In Inner	Pcs In Outer
GA1550	AMIH1550200	200	42	6	0.036	25	400
GA1551	AMIH1551250	250	42	6	0.054	25	250
GA1555	AMIH1555300	300	42	6	0.058	25	250

Finish Available : SAA, PAA

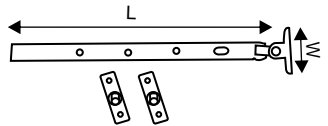

CASEMENT FASTENER



DPG CODE	ITEM CODE	LENGTH	WIDTH	SCREW NO.	WT/PCS	Pcs In Inner	Pcs In Outer
GA1561	AMIH1561XXX	100	54	6	0.043	10	250

Finish Available : SAA, PAA

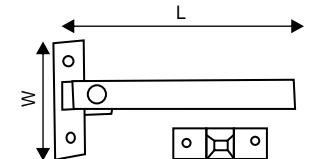

BARREL BOLT



ITEM CODE	ITEM CODE	LENGTH	WIDTH	THICKNESS	SHOOT DIA.	SCREW NO.	WT/PCS	Pcs In Inner	Pcs In Outer
GA1601	AIRN1601050	50	24	0.7	7.5	4	0.023	10	450
GA1602	AIRN1602063	63	24	0.9	7.5	4	0.030	10	400
GA1603	AIRN1603075	73	24	0.9	7.5	4	0.036	10	300
GA1604	AIRN1604100	100	24	0.9	7.5	4	0.048	10	250
GA1605	AIRN1605150	150	24	1.0	7.5	4	0.070	10	160

Finish Available : SAA

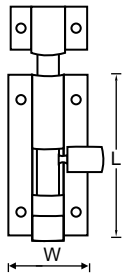

NECKED BARREL BOLT



DPG CODE	ITEM CODE	LENGTH	WIDTH	THICKNESS	SCREW NO.	WT/PCS	Pcs In Inner	Pcs In Outer
GA1651	AIRN1651075	75	25	0.9	4	0.035	10	300
GA1652	AIRN1652100	100	25	0.9	4	0.047	10	250
GA1653	AIRN1653150	150	25	1.0	4	0.070	10	160

Finish Available : SAA

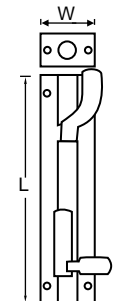

FLUSH BOLT



DPG CODE	ITEM CODE	LENGTH	WIDTH	SCREW NO.	WT/PCS	Pcs In Inner	Pcs In Outer
GA1671	AMIH1671150	150	19	6	0.065	10	100
GA1672	AMIH1672200	201	19	6	0.085	10	100

Finish Available : SAA,

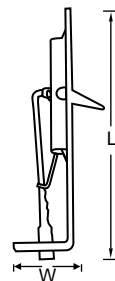

SYMBOLS - SELF ADHESIVE



NAME	DPG CODE	ITEM CODE	LENGTH	WIDTH	THICKNESS	WT/PCS	Pcs In Inner	Pcs In Outer
MALE	GA1700	AMIH1700150	152	100	1.25	0.048	10	200
FEMALE	GA1701	AMIH1701150	152	100	1.25	0.048	10	200
DISABLED	GA1702	AMIH1702150	152	100	1.25	0.048	10	200

Finish Available : SAA, PAA



PUSH & PULL PLATES - SELF ADHESIVE

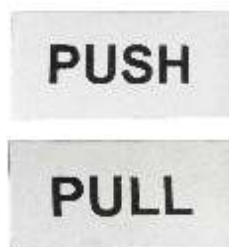

DPG CODE	ITEM CODE	LENGTH	WIDTH	THICKNESS	WT/PCS	Pcs In Inner	Pcs In Outer
GA1710	AMIH1710075	75	38	1.0	0.008	50	500
GA1711	AMIH1711075	75	38	1.0	0.008	50	500

Finish Available : SAA, PAA

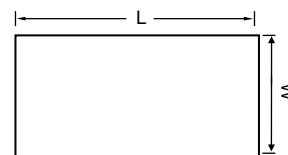

SASH LIFT



DPG CODE	ITEM CODE	LENGTH	WIDTH	THICKNESS	SCREW NO.	WT/PCS	Pcs In Inner	Pcs In Outer
GA1851	AMIH1851050	51	43	1.4	6	0.008	20	500

Finish Available : SAA, PAA
Size Available : HEAVY (GA1852)

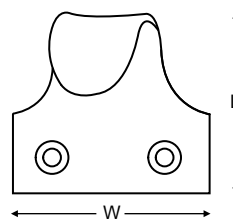

SPINDLE FOR LOCK & LATCHES

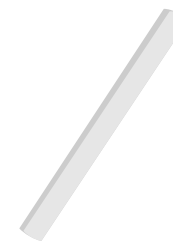

ITEM CODE	LENGTH	SQUARE	WT/PCS	Pcs In Inner	Pcs In Outer
MMIH1061090	90	7.8	0.042	25	400
MMIH1060084	84	7.5	0.035	25	400

Finish Available : SAA, PAA

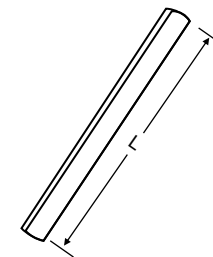



ITEM DESCRIPTION PAGE NO.

ALUMINIUM DOOR, WINDOW FURNITURE & FITTINGS

GA1601	BARREL BOLT 2"	13
GA1602	BARREL BOLT 2.5"	13
GA1603	BARREL BOLT 3"	13
GA1604	BARREL BOLT 4"	13
GA1605	BARREL BOLT 6"	13
GA1004	BATHROOM & PRIVACY FURNITURE	STEPHENSON 3
GA1025	BATHROOM & PRIVACY FURNITURE	BRUNEL 3
GA1044	BATHROOM & PRIVACY FURNITURE	LOWE 3
GA1064	BATHROOM & PRIVACY FURNITURE	WHITWORTH 4
GA1085	BATHROOM & PRIVACY FURNITURE	RUTHERFORD 4
GA1090	BATHROOM INDICATOR	5
GA1341	BOW HANDLE	8
GA1561	CASEMENT FASTENER	13
GA1551	CASEMENT STAY 10"	13
GA1550	CASEMENT STAY 8"	13
GA1555	CASEMENT STAY HEAVY PATTERN 12"	13
GA1088	CON. FIX EURO PROFILE LOCK ESCUTCHEON	5
GA1089	CON. FIX OVAL PROFILE LOCK ESCUTCHEON	5
GA1087	CONCEALED FIX KEYLOCK ESCUTCHEON	5
GA1086	CONCEALED FIX ROUND ROSE LATCH	RUTHERFORD 5
GA1412	COVERED ESCUTCHEON	9
GA1421	CYLINDER PULL	9
GA1423	CYLINDER PULL EURO PROFILE	10
GA1425	CYLINDER PULL OVAL PROFILE	10
GA1351	D" HANDLE 4"	9
GA1352	D" HANDLE 6"	9
GA1702	DISABLED SELF ADHESIVE FIX	14
GA1461	DISHED CUPBOARD KNOB 32MM	10
GA1462	DISHED CUPBOARD KNOB 38MM	10
GA1003	EURO PROFILE FURNITURE	STEPHENSON 3
GA1023	EURO PROFILE FURNITURE	BRUNEL 3
GA1043	EURO PROFILE FURNITURE	LOWE 3
GA1063	EURO PROFILE FURNITURE	WHITWORTH 4
GA1083	EURO PROFILE FURNITURE	RUTHERFORD 4
GA1701	FEMALE SELF ADHESIVE FIX	14
GA1101	FINGER PLATE	5
GA1131	FINGER PLATE PULL	5
GA1121	FINGER PLATE PUSH	5
GA1671	FLUSH BOLT 6"	14
GA1672	FLUSH BOLT 8"	14
GA1451	FLUSH PULL	10
GA1201T	FRONT FIX LETTER PLATE & TIDY	6
GA1201	FRONT FIX LETTER PLATE 10"	6
GA1202	FRONT FIX LETTER PLATE 12"	6
GA1475	HANDRAIL BRACKET	11
GA1481	HAT & COAT HOOK	11
GA1431	INDICATOR BOLT	10
GA1221	INNER FLAP 10"	7
GA1222	INNER FLAP 12"	7

ITEM DESCRIPTION PAGE NO.

ALUMINIUM DOOR, WINDOW FURNITURE & FITTINGS

GA1141	KICK PLATE ROUND EDGE COUNTERSUNK HOLE 30"	6
GA1142	KICK PLATE ROUND EDGE COUNTERSUNK HOLE 33"	6
GA1143	KICK PLATE ROUND EDGE COUNTERSUNK HOLE 34"	6
GA1144	KICK PLATE ROUND EDGE COUNTERSUNK HOLE 36"	6
GA1002	LEVER LATCH FURNITURE	STEPHENSON 3
GA1022	LEVER LATCH FURNITURE	BRUNEL 3
GA1042	LEVER LATCH FURNITURE	LOWE 3
GA1062	LEVER LATCH FURNITURE	WHITWORTH 4
GA1082	LEVER LATCH FURNITURE	RUTHERFORD 4
GA1001	LEVER LOCK FURNITURE	STEPHENSON 3
GA1021	LEVER LOCK FURNITURE	BRUNEL 3
GA1041	LEVER LOCK FURNITURE	LOWE 3
GA1061	LEVER LOCK FURNITURE	WHITWORTH 4
GA1081	LEVER LOCK FURNITURE	RUTHERFORD 4
GA1700	MALE SELF ADHESIVE FIX	14
GA1651	NECKED BARREL BOLT 3"	13
GA1652	NECKED BARREL BOLT 4"	13
GA1653	NECKED BARREL BOLT 6"	13
GA1411	OPEN ESCUTCHEON	9
GA1322	OVAL GRIP PULL HANDLE 12"	8
GA1321	OVAL GRIP PULL HANDLE 9"	8
GA1024	OVAL PROFILE FURNITURE	BRUNEL 3
GA1045	OVAL PROFILE FURNITURE	LOWE 3
GA1065	OVAL PROFILE FURNITURE	WHITWORTH 4
GA1084	OVAL PROFILE FURNITURE	RUTHERFORD 4
GA1486	OVAL SHEILD DOOR STOP	12
GA1711	PULL PLATES ADHESIVE	14
GA1710	PUSH PLATES SELF ADHESIVE	14
GA1211	REAR FIX LETTER PLATE	7
GA1317	ROUND BAR PULL HANDLE- BOLT THROUGH FIXING 12"	8
GA1315	ROUND BAR PULL HANDLE- BOLT THROUGH FIXING 6"	8
GA1316	ROUND BAR PULL HANDLE- BOLT THROUGH FIXING 9"	8
GA1313	ROUND BAR PULL HANDLE- CONCEALED FIX 12"	7
GA1314	ROUND BAR PULL HANDLE- CONCEALED FIX 18"	7
GA1311	ROUND BAR PULL HANDLE- CONCEALED FIX 6"	7
GA1312	ROUND BAR PULL HANDLE- CONCEALED FIX 9"	7
GA1488	ROUND SHEILDED DOOR STOP	12
GA1852	SASH LIFT HEAVY	15
GA1851	SASH LIFT 2"	14
GA1061A	SPINDLE FOR LOCK & LATCHES 125MM	15
GA1061B	SPINDLE FOR LOCK & LATCHES 90MM	15
GA1483	TOILET ROLL HOLDER	11
GA1483A	TOILET ROLLER	12
GA1484	TUBULAR DOOR STOP	12
GA1485	TUBULAR DOOR STOP	12
GA1482	WARDROBE HOOK	11

NOTE

* All Weight Given are Approximate and can Vary

* All Data & Photos Printed In This Catalogue Represent The Product to Close Details, However There May Be Some Variations in Real Product & Photograph.

* All Information and Photograph is Property of **D. P. GARG PVT. LTD.**
It is illegal to reproduce any photograph & data without prior written consent of the company.

KEY FINISHES

SAA	SATIN ALUMINIUM ANODIZED
PAA	POLISHED ALUMINIUM ANODIZED